

## Edge of Arlington Saw & Tool, Inc.

124 South Collins  
Arlington, TX 76010  
Phone: 817-461-7171 • Fax: 817-795-6651  
Toll Free: 888-461-7171  
Email: [info@eoasaw.com](mailto:info@eoasaw.com)  
Website: [www.eoasaw.com](http://www.eoasaw.com)



### Item #61311, Amana Tool Insert Carbide Aluminum Adjustable Chamfer -90.0 to +90.0 x 170mm (6-11/16) Dia x 60mm (2 in) x 1-1/4 Bore (Industrial) \$470.24

Thank you for shopping with us! Cutterhead bodies available in hard wearing aluminum or steel, complete with tungsten carbide knives. Suitable for producing chamfer cuts at various angles in softwood, hardwood, and man-made boards on a spindle molder. Cutting angle can be adjusted in 7.5° increments by using notched scale. Fine adjustment of 1° is also possible.

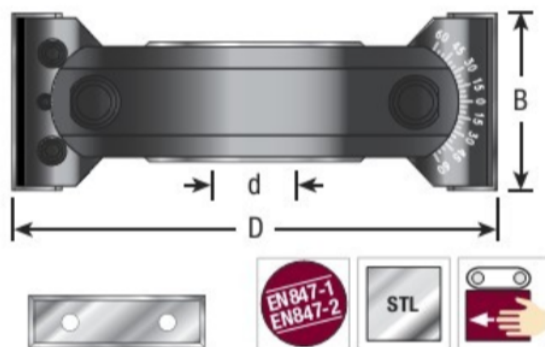

## SPECIFICATIONS

<b>Manufacturer</b>	Amana Tool
<b>Diameter</b>	6 11/16 in
<b>Bore</b>	1 1/4 in
<b>Cut Height, Length, or Width</b>	2 in
<b>Knives</b>	ICK-60
<b>Overall Length</b>	6 11/16 in
<b>RPM</b>	4,500 to 6,000
<b>Note</b>	Has special mechanism to enable fine tuning angle of 1 deg